

PLAT OF SURVEY

-OF-

PARCEL 1:
THE NORTHEASTERLY 35 FEET (MEASURED ON THE EASTERLY LINE OF LAKE AVENUE) OF THE FOLLOWING DESCRIBED PROPERTY: BEGINNING AT A CONCRETE MONUMENT ON THE EASTERLY SIDE OF LAKE AVENUE AND BEING THE SOUTHWEST CORNER OF LOT 1 IN BLOCK 1 OF D.A. REID'S ADDITION TO REID'S PARK AFORESAID; THENCE NORTHEASTERLY ON SAID EASTERLY LINE OF LAKE AVENUE, 51.3 FEET TO AN IRON PIPE; THENCE CONTINUING NORTHEASTERLY ON SAID EASTERLY LINE OF LAKE AVENUE 14.13 FEET; THENCE EASTERLY 3.62 FEET TO A CONCRETE MONUMENT; THENCE CONTINUING EASTERLY ON THE SAME COURSE 18.94 FEET TO A CONCRETE MONUMENT; THENCE CONTINUING EASTERLY ON THE SAME COURSE 12 FEET MORE OR LESS TO THE SHORE LINE OF GENEVA LAKE; THENCE SOUTHERLY ALONG THE SHORE LINE OF GENEVA LAKE TO A POINT 31.69 FEET EASTERLY OF THE POINT OF BEGINNING; THENCE WESTERLY 12 FEET TO A CONCRETE MONUMENT; THENCE CONTINUING ON THE SAME COURSE WESTERLY 19.69 FEET TO THE POINT OF BEGINNING, ALL IN WALWORTH COUNTY, WISCONSIN.

PARCEL 2:
THE NORTH 20 FEET OF LOT 1 AND THE SOUTH 30.43 FEET OF LOT 1 EXCEPT THE SOUTH 15 FEET THEREOF IN BLOCK 1 OF D.A. REID'S ADDITION TO REID'S PARK, FONTANA-ON-GENEVA LAKE, IN WALWORTH COUNTY, WISCONSIN.
THE ABOVE LAND DESCRIBED BY SURVEYS OF ROBERTS & FISCHER INC., SURVEYORS, DATED JULY 30, 1970 AS FOLLOWS: BEGINNING ON THE EAST LINE OF LAKE AVENUE AT THE NORTHWEST CORNER OF BLOCK 1 THENCE SOUTHERLY ALONG THE EAST LINE OF LAKE AVENUE, 20.08 FEET, TO AN OAK TREE, THENCE EASTERLY 30.93 FEET TO THE LAKE SHORE, THENCE NORTHERLY ALONG THE LAKE SHORE 20.1 FEET TO THE NORTH-EAST CORNER OF LOT 1 BLOCK 1 OF SAID REID'S ADDITION TO REID'S PARK, THENCE WESTERLY ALONG THE NORTH LINE OF SAID LOT 1 BLOCK 1, 30.9 FEET MORE OR LESS TO THE PLACE OF BEGINNING, ALSO BEGINNING AT AN IRON PIPE 15.45 FEET NORTHEASTERLY OF THE SOUTHWEST CORNER OF LOT 1 BLOCK 1 SAID REID'S ADDITION TO REID'S PARK, THENCE NORTHEASTERLY ALONG THE EAST LINE OF LAKE AVENUE, 14.95 FEET THENCE EASTERLY TO THE LAKE SHORE 33.58 FEET MORE OR LESS THENCE SOUTHERLY ALONG THE LAKE SHORE 14.5 FEET; THENCE WESTERLY 30.91 FEET MORE OR LESS TO THE PLACE OF BEGINNING.



LEGEND
○ FOUND IRON PIPE
□ FOUND IRON BAR
⊕ CONCRETE MONUMENT
⬢ COUNTY MONUMENT
⊗ BUOY
(XX) RECORDED AS
TAX ID # SRA00001, 2 & 4
JOB # 11-139

I have surveyed the above-described property and the above map is a true representation thereof and shows the size and location of the property, its exterior boundaries, the location and dimensions of all structures thereon, fences apparent easements and roadways and visible encroachments, if any.

This survey is made for the exclusive use of the present owners of the property, and also those who purchase, mortgage, or insure the title thereto within one (1) year from date hereof, and as to them I warrant the accuracy of said survey map.

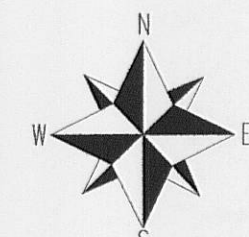

SCALE 1"=20'

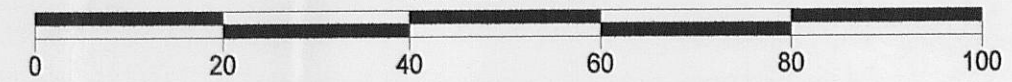

NOTE: BEARINGS REFERENCED TO THE SOUTH LINE OF THE NORTHWEST 1/4 OF SECTION 14-1-16
NOTE: BEARINGS HEREON RELATED TO GRID NORTH OF THE WISCONSIN STATE PLANE COORDINATE SYSTEM GRID, SOUTH ZONE (NAD-27)

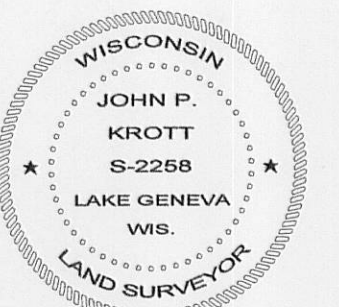
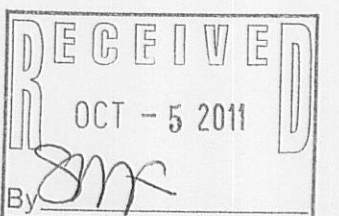

DATED THIS 26th DAY OF SEPTEMBER 2011.

JOHN KROTT S-2258
Wisconsin Registered Land Surveyor
(original if signed in red)

005-2855